

# MONTE CARLO



Sunliner Motorhomes





# MONTE CARLO

BY SUNLINER

A luxury recreational vehicle for the most discerning traveller.

The Sunliner Monte Carlo series is the flagship of the Sunliner range of Recreational Vehicles and is tailored to the unique journey of its new owner. A beautiful, distinctive design is only the beginning. The story begins long before you step inside or get behind the wheel, with innovative engineering, cutting-edge construction techniques and a meticulous attention to detail. Measuring over 9 meters in length and laden with the latest technologies available, the Monte Carlo is the “no compromise” luxury touring vehicle.

Discover why so many people choose Sunliner

## Quality

Enjoy total confidence knowing that your new Sunliner has been manufactured in Australia to a world class standard. The quality of your vehicle can be seen, heard and felt in the finished product where the attention to detail is evident.

## Experience

Since humble beginnings in 1974 Sunliner has earned a strong reputation for building quality recreational vehicles. To this day Sunliner continues to lead the industry in design and technological innovations. Your RV is manufactured to a standard which only experience can create.

## Innovation

Thanks to a culture of innovation, you can rest assured that your Sunliner contains the latest concepts and technologies such as the ThermoTough Wall and DuraRoof. Sunliner layouts and interior styles set trends that others follow.

## Assurance

Sunliner is a foundation member of the Caravan Industry of Association of Australia's Recreational Vehicle Manufacturing Accreditation Program RVMAP, assuring customers that the highest design and manufacturing standards are being met and independently verified.





# The luxury of abundant space

The magic in the Monte Carlo is the space created by having sliding walls. With just the push of a button, you can have your very own spacious apartment on wheels.



KEY				LENGTH	9.5M
1	Bed	4	Washing Machine	7	Storage
2	Seat	5	Microwave & Fridge	8	Robe
3	Table	6	Pantry	9	TV
				WIDTH	2.5M
				HEIGHT	3.35M

MC1

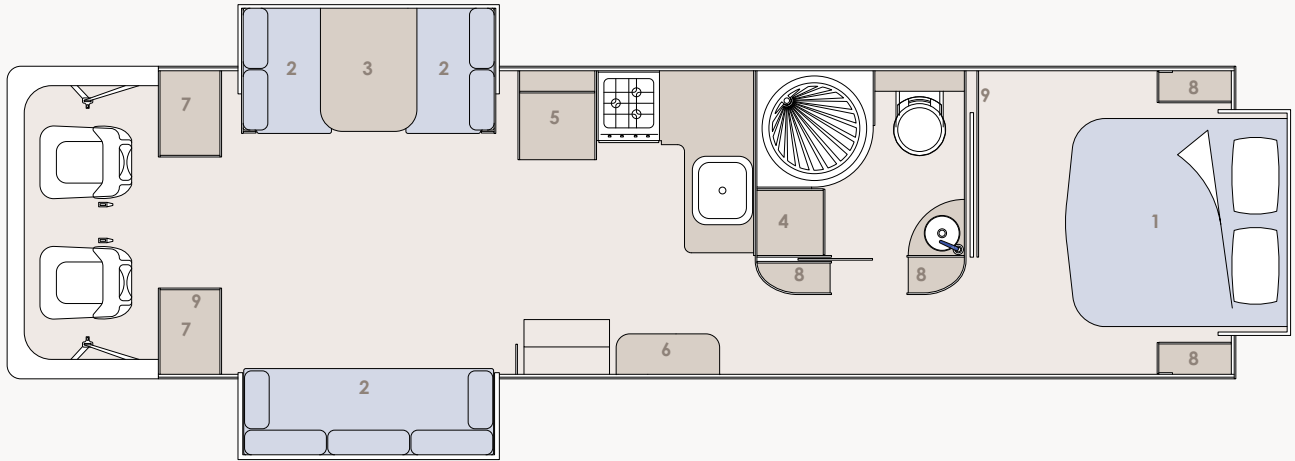

MC2

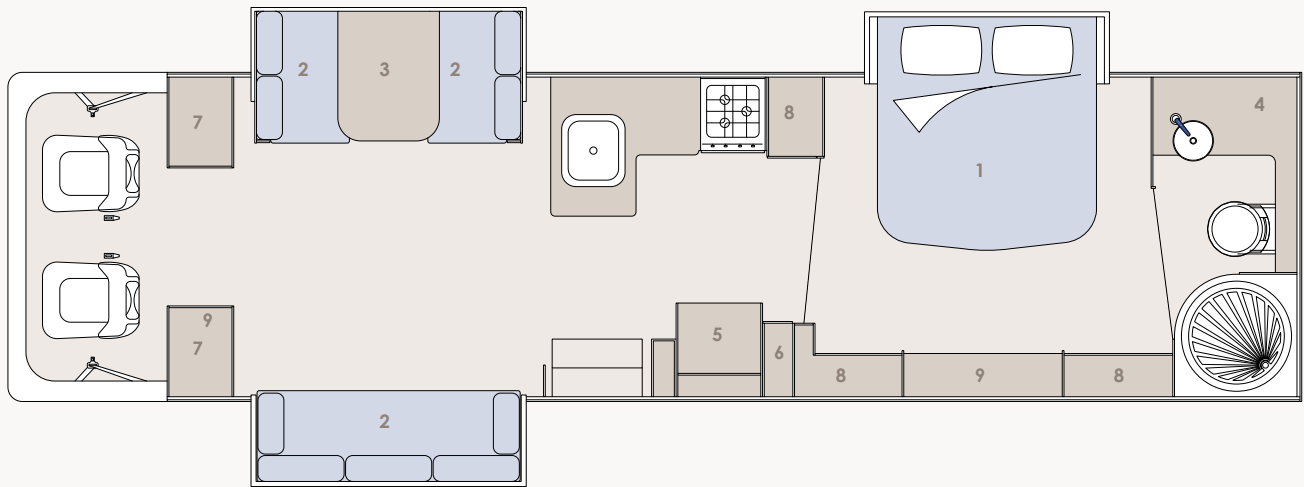



LENGTH	9.5M
WIDTH	2.5M
HEIGHT	3.35M

KEY

- |         |                      |           |
|---------|----------------------|-----------|
| 1 Bed   | 4 Washing Machine    | 7 Storage |
| 2 Seat  | 5 Microwave & Fridge | 8 Robe    |
| 3 Table | 6 Pantry             | 9 TV      |

MC3

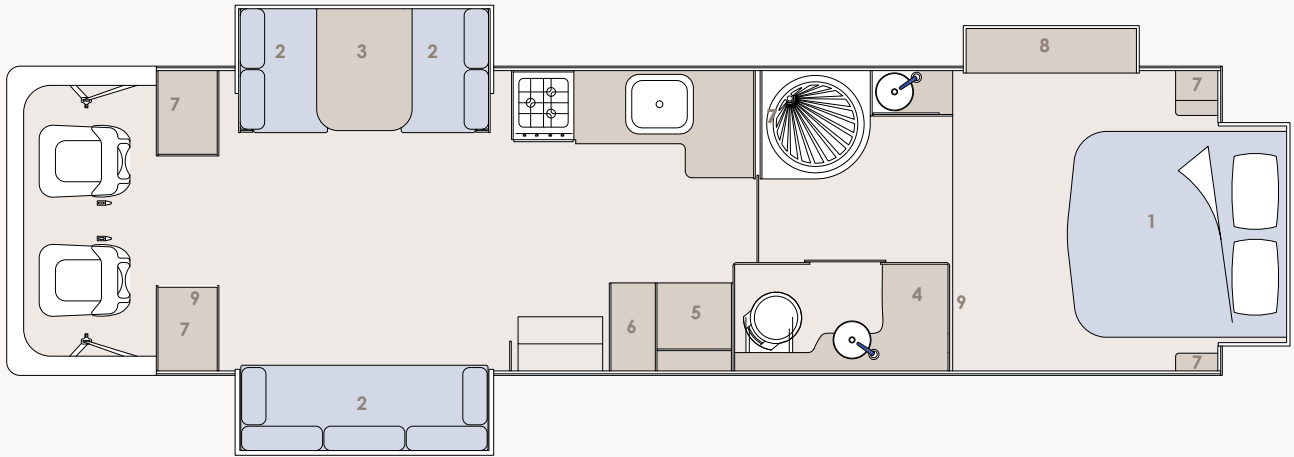

MC4

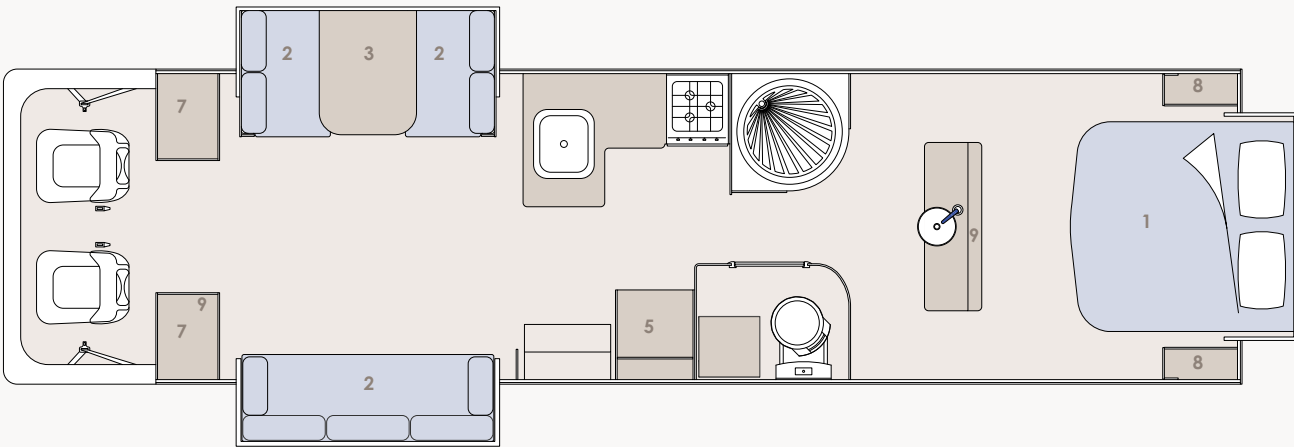

Zoned living creates privacy and function

The Monte Carlo employs a zoned living approach to design to create separate living, bathroom and bedroom areas. Now you can enjoy the same level of privacy and function in your Monte Carlo as you do at home.





# Tailored to you

From the moment you step inside, it’s evident that this is the luxurious reward you deserve for all your hard work. With choices in layout and interior finishes, your Monte Carlo will become a reflection of your unique style and the dream lifestyle you wish to create.



## Eye for detail

Everywhere you turn, decadence abounds from the indulgent kitchen to the 5-star hotel like bathroom suite.



## STYLE

### SOHO FINISH

A contemporary finish with a combination of clean lines, high gloss cabinets and generous bench-tops that produce a space that is fresh and sophisticated. Choose from a variety of cabinetry inserts to create a space that makes a statement that is uniquely yours.



### NAUTIQUE FINISH

Inspired by the luxurious décor of a private yacht, the Nautique finish speaks to old world charm and a spirit of adventure. With polished Australian hardwood and gentle curves; the overall effect is warm, inviting with a quality that is undeniable.



### NOUVEAU FINISH

A finish with understated glamour inspired by the art déco period. Rounded edges, contrasting colours, high gloss surfaces and strong tapware shapes come together to forge an interior that is at the same time classic and modern.





All of the features that others call “extras” are included as standard in your Monte Carlo. A generator, washing machine, solar panels, inverter and a coffee machine; these are just a few of the standard inclusions that make your Monte Carlo the complete touring package.

SPECIFICATIONS

CABIN	
Cabin seats upholstered to match interior	•
Reverse Camera	•
Cabin Reading Lights	•
In dash GPS	•
KITCHEN	
2 door 180 Ltr Fridge	•
3 Burner Gas Stovetop, Oven & Grill	•
Microwave	•
Rangehood	•
Acrylic Splashback	•
Outdoor kitchen incl. BBQ, fridge and sink	•
Coffee Machine	•
Dyson Vacuum cleaner	•
LIGHTING	
LED Ceiling Lights	•
LED Reading Lights	•
LED Feature Strip Lights	•
LED Awning Strip Light	•
POWER SYSTEM	
50A 240V Charger	•
150Ah In House Battery	2
140w Solar Panel & Regulator	2
3000w Inverter	•
3.6kva Generator	•
PLUMBING	
Ceramic Toilet	•
Top Loading Washing Machine	•
20ltr Gas/Electric Hot Water Service	•
250 ltr Fresh Water Capacity	•
90ltr Grey Water Capacity	•
Hose Reel with Auto Fill Tap	•
External Shower	•
9 kg Gas Bottles	2

CLIMATE	
Air Conditioner	•
Diesel Heater	•
Bedroom Roof Fan Hatch	•
Peak Sky Hatch	•
Bathroom Roof Fan Hatch	•
EXTERNAL	
Entry Door with Security Screen	•
Electric Awning	•
Double Glazed Single Hopper Windows	•
Illuminated External Grab Handle	•
Electric Entry Step	•
External Roof Bars	•
Fibreglass Bumper & Spoiler	•
Tow Bar and Bull Bar	•
Electric Auto Levelling Jacks	•
Roof Bars	•
External Power Point	•
External Grab Handle	•
External 24" TV	•
External Speakers	•
Auto Level Jacks	•
ENTERTAINMENT	
32" LCD TV with in built DVD Player - Lounge area	•
32" LCD TV in bedroom area	•
24" LCD TV - exterior	•
Zoned Internal Speakers	4
TV Antenna	•
FURNISHINGS	
Innerspring Mattress - Main bedroom	•
Foam 4" peak mattress	•
Curtains	•
Upholstery - leather or fabric	•
Dinette Seat extension	•
1.8m Couch - folds to double bed	•

- Standard



CHASSIS



	NQR 450
Engine	5.2L TD
Power (hp/kw)	139
Tourque (Nm)	510
GVM (kg)	8700
Front Axle Capacity	3100
Rear Axle Capacity	6600
Transmission	6 Speed Auto
Fuel Tank Capacity (Litres)	140
Driven Wheels	Rear
Tyre Size	255/70R19.5
Anti-Lock Brakes (ABS)	•
Traction Control	•
Stability Control	•
Roadside Assistance	•
Warranty Period (Years/km's)	3/200,000

- Standard

WHAT SETS US APART

**Quality**  
Concealed spring assisted adjustable hinges are used for smoother assisted opening.

**Rear to Tow, Front to Go.**  
Sunliner offer more layouts on a greater variety of chassis than any other.

**Steel Sub Chassis**  
Stronger than a panel floor which allows a strong foundation with less movement in the vehicle body. More secure mounting for walls, tanks & bins.

**It's what you don't see that counts.**  
All Fibreglass fairings are neatly screwed & glued in a way that they can't be seen; giving a neater appearance and assists in a cleaner unit.

**No Frame, More Gain**  
The innovative ThermoTough Wall, allows the unit to be built without a rigid frame. Mounting can be made at any point internally or externally directly into the seamless 12mm core.

**Floor**  
One piece floor has no joins and is fully sealed underneath. Internal floor coverings are high quality and insulated.

**Locked tight, made right.**  
Walls are rebated and interlocked for a stronger construction with more support.

**It's the things you don't see that counts.**  
Furniture is sealed around the floor to prevent spills getting in to unreachable places.

**DuraRoof™**  
*Strong enough to Party On*

Sunliner's DuraRoof has been precision engineered to provide superior structural strength.

- Fully insulated bonded core.
- Reinforced timber structure combined with compressed Duplo Foam.

**ThermoTough™ Wall**  
*The Toughest Walls on the Market*

Sunliner's ThermoTough wall is a revolutionary design encompassing strength, durability and weight reducing properties.

- Lightweight european technology.
- One piece wall. No joins. No gaps. Equals greater strength.
- Popular cross ply/Duplo Foam core provides extremely strong panel with a high impact rating.

- Most repairs can be localised without replacing the whole wall.
- All materials used in the process have similar expansion rates.
- Walls can be screwed into at any point. No studs or fixing points necessary.
- Walls R rating is equivalent to those found in extreme alpine areas.

# PERSONALISE YOUR JOURNEY...

## CAMPERVANS



The Sunliner Campervan range includes the entry level Vida range and the more highly specified Rialta. Both ranges include the pop-top and full bodied vans with a choice of chassis.



## RANGER

Available in 2x4 or 4x4, with Diesel or Gas appliances; you now have the freedom to go almost anywhere.



## SWITCH

The Switch is the entry point to Sunliner's mid size motorhome range. Simple and sophisticated the Switch is well equipped and modern; making the motorhoming lifestyle easy.



## PINTO

Offering electric drop-down bed and island bed layouts, this range encompasses the best of a touring van in a compact stylish package.



## NAVIAN

The Sunliner Navian is a series of premium RVs. Designed to provide the widest choice of layouts, chassis, peaks and style, to enable personalisation, The Navian series offers drop down beds, slides out walls and everything in between.



## MONTE CARLO

The Flagship of the Sunliner range, the Monte Carlo is in a class of its own. The finest trims, leather upholstery, curved cabinetry and feature lighting create a space that is the pinnacle of luxury.

Please note that some layouts may not accommodate the standard items listed in this brochure. The closest alternative will be fitted. All capacities, weights and measurements listed are approximates. All specifications and options on this brochure may be charged at any given time according to availability and supply. Floor plans are dependent on chassis type and dimensions may change depending on base chassis. Images shown may not depict the actual model or may contain items not standard or available with specific model. It is the customer's responsibility to ensure that the vehicle purchased is suited to their needs. This brochure may not be relevant to dealer stock units purchased or second-hand units. This brochure should be used as a guide only.

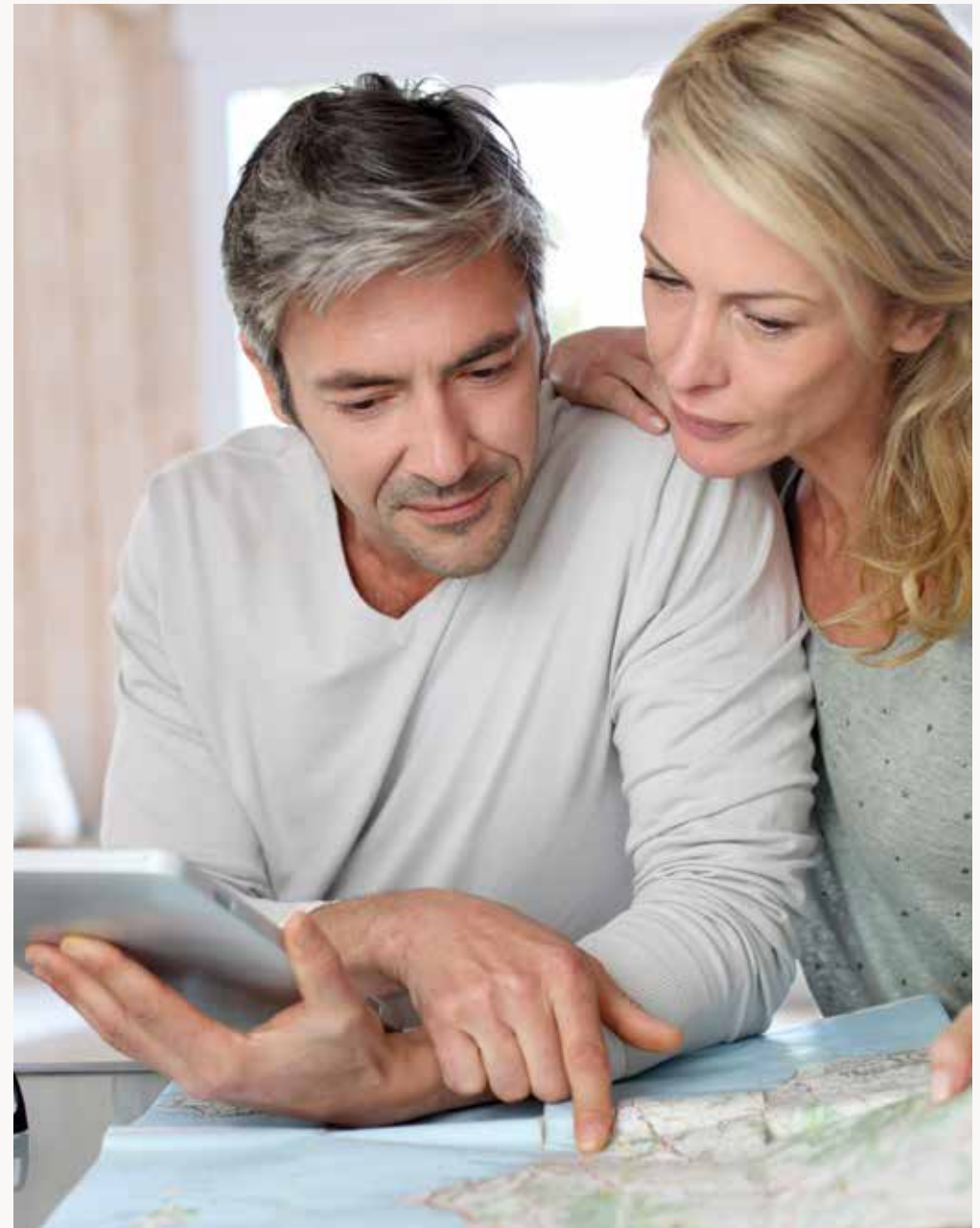

## You're Invited

Please join us at [www.sunlinercommunity.com.au](http://www.sunlinercommunity.com.au)  
an online community of like-minded travellers,  
where you can plan adventures, exchange advice  
and keep up to date with the latest Sunliner news.

[www.sunliner.com.au](http://www.sunliner.com.au)