

HABITAT



GO FURTHER STAY LONGER

A multi-terrain masterpiece. The Habitat is a touring motorhome designed for the free camper who wants to travel further, camp more remotely and stay longer.

FEATURES

- Multi-Terrain- With features such as higher ground clearance, all terrain tyres, checker plate finish, increased rear departure angle, and forward protection bar.
- Take your toys- The HA1 & HA2 Sunliner Utility Garage allows for the greatest storage of any RV on the Australian & New Zealand market.
- Stay Longer- Increased fresh water and grey water storage, additional solar panels and battery capacity. Truly allowing you to stay longer.
- Extra Security- 360 degree security lighting, UHF radio and forward facing camera with DVR keeping you safe.

KEY INFORMATION					
	HA1	HA2	HA3	HA4	HA5
LENGTH	8.8M	8.2M	5.9M	7.9M	7.5M
WIDTH	2.5M	2.5M	2.2M	2.3M	2.5M
HEIGHT	3.3M	3.3M	3.3M	3.3M	3.3M
SLEEPS	2/4	2/4	2	2	2/4
GVM	6500kg	4495kg 6500kg	3650kg	4495kg	4495kg
LICENSE	LR	LR	CAR	LR	CAR
UTILITY GARAGE	YES	YES	NO	NO	NO
UTILITY BAR	YES	YES	-	YES	YES

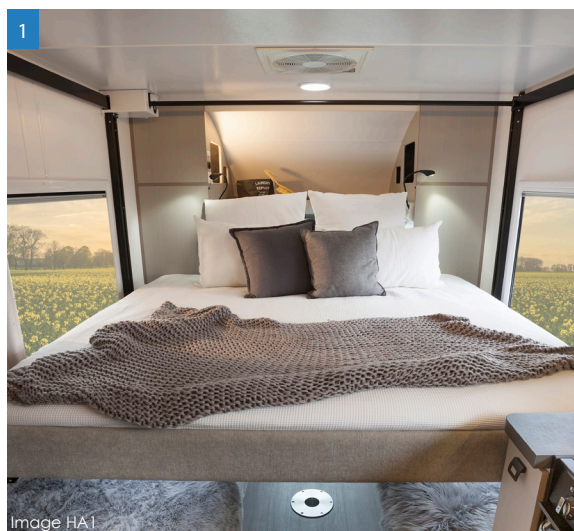
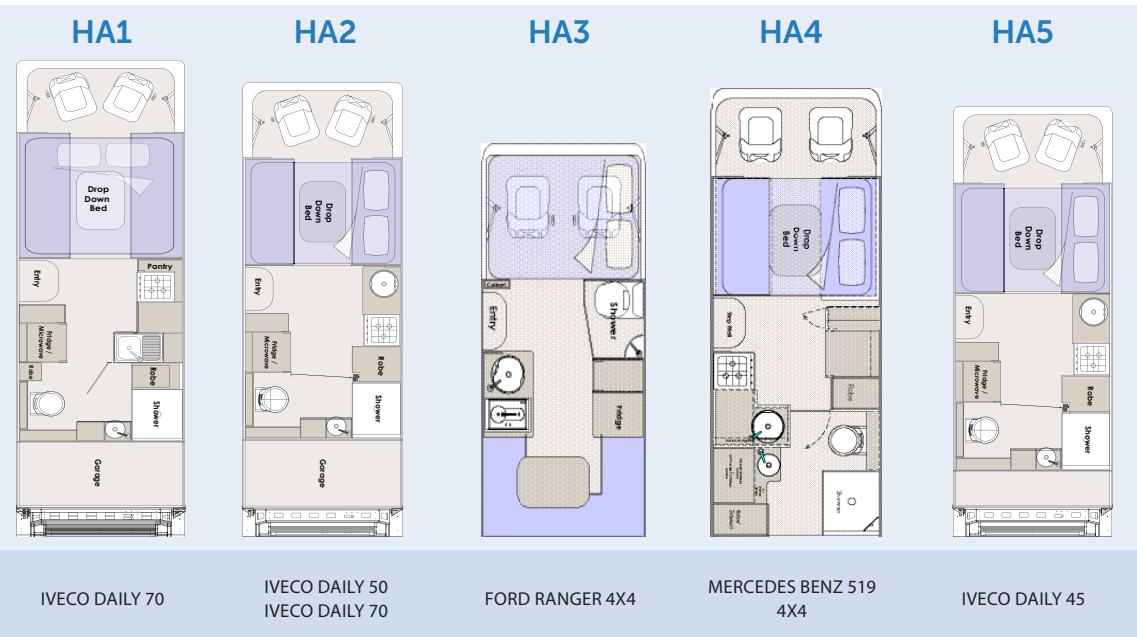

1. Wake to panoramic views out of the large insulated single hopper windows from your North/South electric drop down bed. 2. Get dressed in privacy in your large bathroom with ample storage with drawers, overhead lockers and wardrobe 3. Standard in the HA1 & HA2 the Utility Garage electric drop-down platform combined with the dual slide sliding deck allows you to pack your all of your long term needs. 4. Large ultra leather lounges allow for a roomy dining area and lazy days. They can also double as single beds in the HA1. Separate fresh water tap with filter & stove oven combination completes the modern functional kitchen.

HOME SPECIFICATIONS

	HA1	HA2	HA3	HA4	HA5
CABIN / CHASSIS					
All Terrain Tyre UPGRADE	*	*	*	*	*
Alloy Wheel Upgrade	-	-	*	-	-
Blockout Window Thermal Blind Set	*	*	*	*	*
DVR Forward Camera Recorder	*	*	*	*	*
Front Protection Nudge Bar	*	*	*	*	*
Iveco 210lt Fuel Tank Upgrade	*	-	-	-	-
Light Bar 22"	*	*	*	*	*
Reverse Camera	*	*	*	*	*
Swivel Driver & Passenger Seat	*	*	-	*	*
UHF CB Radio	*	*	*	*	*
CLIMATE CONTROL					
Air Conditioner 2400W	*	*	*	*	*
Diesel Heater 2 KVA	*	*	*	*	*
Roof FAN Bathroom Hatch	*	*	*	*	*
Roof FAN Hatch Fiamma Turbo	*	*	*	-	*
ELECTRICAL LIGHTING					
Boot Light With Switch	-	-	*	-	-
External Security Lighting Roof Light Bar 22 Inch	3	3	-	3	3
LED Strip In Step Well	*	*	*	*	*
Reading Lights	-	-	2	-	-
ELECTRICAL POWER SYSTEMS					
12V BMS Control System Redarc	*	*	*	*	*
Battery 135 LITHIUM	3	3	2	3	2
Double USB + 12v Socket	*	*	*	*	*
External 240 Power Inlet	*	*	*	*	*
External 240 Power Outlet	*	*	*	*	*
Generator 2.3 KVA	*	-	-	-	-
Inverter 2000w Pure Sign Wave	-	-	*	*	-
Inverter 3000w Pure Sign Wave	*	*	-	-	*
Solar Panel 170w	3	2	1	2	2
ENTERTAINMENT					
Speakers External Pair	*	*	*	*	*
Speakers Internal Pair	*	*	*	*	*
Stereo Fusion MS-RA55	-	*	*	*	*
Stereo Fusion MS-RA770	*	-	-	-	-
TV Antenna External	*	*	*	*	*
TV Combo 24" Internal	*	*	*	*	*
EXTERNAL					
Entry Step Electric	*	*	*	*	*
External Table	*	*	*	*	*
Roof Bars	*	*	*	*	*
EXTERNAL AWNINGS MAIN					
Electric	*	*	-	*	*
Wind Out	-	-	*	-	-
EXTERNAL STEEL COMPONENTS					
Cabin Side Steps Steel	*	*	*	*	*
Utility Bar	*	*	-	*	*
HANDLES					
External Entry Illuminated	*	*	*	*	*
Internal Entry Large Wave	*	*	-	*	*
Positive Catch Handles	*	*	*	*	*
KITCHEN					
3 Gas Burner + Oven And Grill Combo	*	*	-	*	*
3 Gas Cooker	-	-	*	-	-
Bench Extension	-	-	*	-	-
Microwave	*	*	*	*	*
Rangehood	*	*	*	*	*
Sink Round With Lid	-	*	*	*	*
Sink With Drainboard	*	*	-	-	-
Splashback	*	*	*	*	*

	HA1	HA2	HA3	HA4	HA5
Water Purifier With Separate Tap					
2 Way 150L	-	-	-	*	-
2 Way 185L	*	*	-	-	*
2 Way 90L	-	-	*	-	-
MATTRESS					
Double 4'6" x 6'2" x 6'	-	*	-	*	*
Double Foam 1370x1850x100	*	-	*	-	-
King 6' x 6' 2" x 6'	*	-	-	-	-
PLUMBING ITEMS					
Toilet Ceramic	*	*	-	*	*
Toilet Plastic	-	-	*	-	-
Vanity Basin Sink Ceramic	*	*	-	*	*
External Mains City Water	*	*	*	*	*
External Shower	-	*	*	*	*
External Water Filler	*	*	*	*	*
Flow Meter For Fresh Water	*	*	*	*	*
Gas Bottles 4kg	2	2	1	2	2
Hot Water Service Gas	*	*	*	*	*
Water Pump	*	*	*	*	*
PLUMBING TANKS					
Tank Fresh (Ltr)	400	300	150	400	200
Tank Waste (Ltr)	100	100	50	100	100
SAFETY					
Fire Extinguisher	*	*	*	*	*
Internal Gas Detector Alarm	*	*	*	*	*
Internal Smoke Alarm	*	*	*	*	*
Internal Step Carpet Mat Sunliner	*	*	*	*	*

CHASSIS SPECIFICATIONS

	FORD RANGER- 4X4 HIGHRIDER	IVECO- DAILY 45 C18A8	IVECO- DAILY 50 C18HA8	IVECO- DAILY 70 C21HA8/P	MERCEDES BENZ- SPRINTER 519- 4X4
Engine	3.2 Ltr	3.0 Ltr	3.0 Ltr	3.0 Ltr	3.0 Ltr
Power (hp/kw)	197/147	176/130	180/132	210/155	190/140
Torque (Nm)	470	400	430	470	440
GVM (kg)	3200	4495	4495/5200	7200	4490
Transmission	6 Speed Auto	8 Speed Auto	8 Speed Auto	8 Speed Auto	7 Speed Auto
Driven Wheels	4 x 4	Rear	Rear	Rear	All Wheel Drive
Tyre Size	265/70 R16	195/75 R16	195/75 R16	225/75 R16	205/75 R16
Ani-Lock Brakes (ABS)	STD	STD	STD	STD	STD
Traction Control	STD	STD	STD	STD	STD
Stability Control	STD	STD	STD	STD	STD
Warranty Period (Years/Km's)	5 yr Unlimited	3 yr/200,000	3 yr/200,000	3 yr/200,000	5 yr/250,000
Wheel Base	3220	4350	4750	4750	4325
ECAS	-	-	-	-	-
DIFF LOCK	-	STD	STD	STD	-
Suspension Seats	-	-	STD	STD	-

To explore more take a photo of the below QR codes



MORE HABITAT



IMAGES & 360 TOURS



ABOUT US



DEALERS



IN STOCK



GARAGE

Due to continuous improvements and availabilities, specifications, inclusions & brands are subject to change without notice. All capacities, weights, lengths and measurements are approximates. Images used may not depict the actual model or may contain items that are not standard or available.

This document should be used as a guide only.
For more detailed information please contact your local dealer.

www.sunliner.com.au

