

HOLIDAY



Sunliner Motorhomes



Everyday can be a Holiday

The Sunliner Holiday RV series is the perfect vehicle to drive your adventures across this vast country. Built to the Sunliner standard and offering the unique easy 6 step process to personalise your motorhome. The Holiday can become the motorhome of your dreams.

Accommodating all tastes and styles, this easy to follow personalisation system gives you more choice than any other; including layout, chassis, peak, finish, style and specification. You can create a motorhome that perfectly suits your individual requirements.

As soon as you explore the Sunliner Holiday RV series you will see that it stands out for its innovation, craftsmanship and finish.



6 Step Personalisation Process

Step 1: Select your Layout. With 16 to choose from you are sure to find the one that works for you.

Step 2: Select your Chassis. We offer a choice of 7 different chassis from 4 different manufacturers to provide you with the most options.

Step 3: Select your Peak. High or Low to meet the needs of your journey.

Step 4: Select your Style. Sleek modern high gloss or warm timbers with soft corners; the choice is yours from our 6 style options.

Step 5: Select your Finish. We offer a huge range of choice of floors, soft furnishings, trims, splashbacks and more, so you can truly personalise your Motorhome.

Step 6: Select your Specifications. Will you be free camping in national parks or staying in caravan parks? You can choose the specifications package to suit your travelling requirements.

1

Choose your Layout

H501

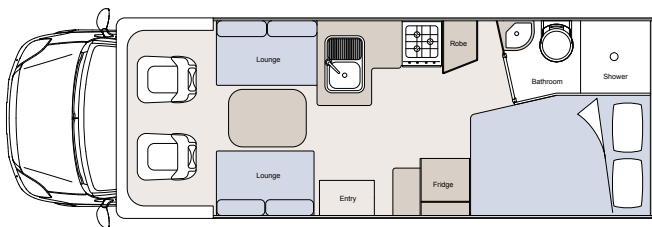

Layout Option: Straight kitchen bench.

Length 7.5m

Width 2.47m

Height 3.25m

H504

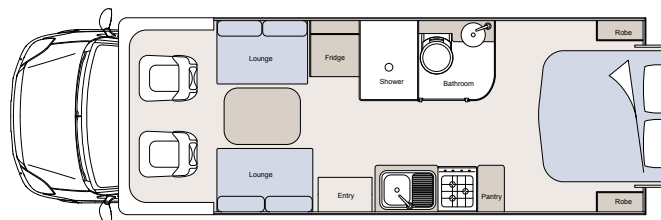

Length 7.5m

Width 2.47m

Height 3.25m

H502

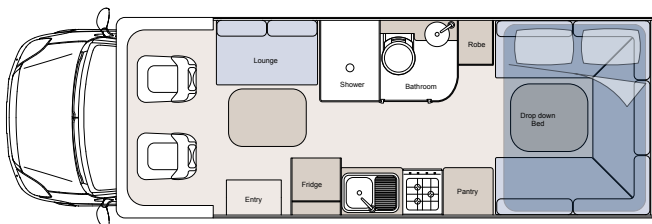

Layout Option: Forward facing seats

Length 7.5m

Width 2.47m

Height 3.25m

H503

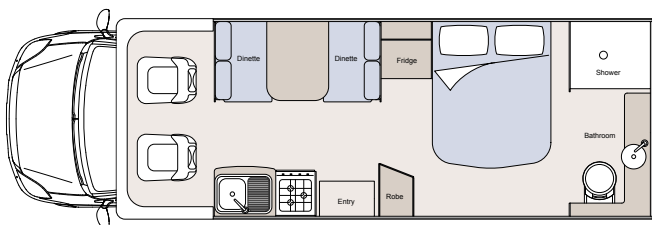

Layout Option: L shape lounge.

Length 7.5m

Width 2.47m

Height 3.25m

No one knows what works for you, better than you

You know what works for you, that is why at Sunliner we think you also know what you are looking for in a recreational vehicle (RV). Our philosophy is to listen and work with you to create your dream vehicle.

We understand that you want your new RV to feel like a home and we don't believe you should have to compromise.

Our vehicles do not come from an offshore assembly line, with a single mould for everyone. Each Sunliner RV is built in Australia by our skilled team who are excited to manufacture recreational vehicles tailored to your needs.

Sunliner is proud to be an Australian owned family business. We have been manufacturing outstanding Motorhomes for over 40 years. It is our innovation and our attention to detail that sets Sunliner apart as Australia's premium brand of Recreational Vehicles.

We look forward to assisting you to personalise your journey.

H505

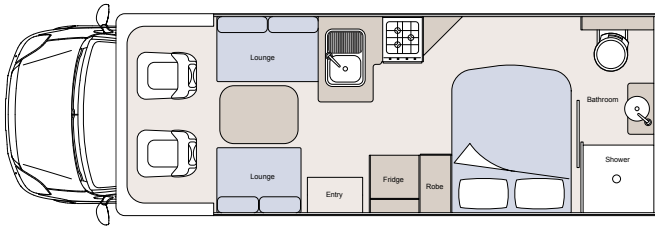

Layout Option: Straight bench in kitchen.

Length 7.5m

Width 2.47m

Height 3.25m

H508

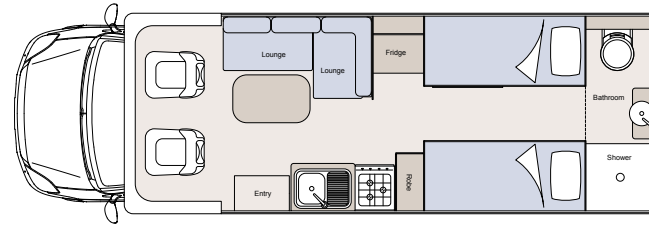

Length 7.5m

Width 2.47m

Height 3.25m

H506

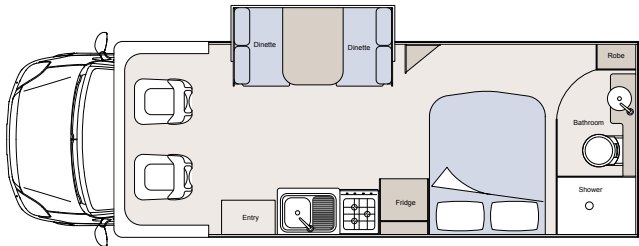

Layout Option: L shape bench in kitchen and L shape lounge.

Length 7.5m

Width 2.47m

Height 3.25m

H531

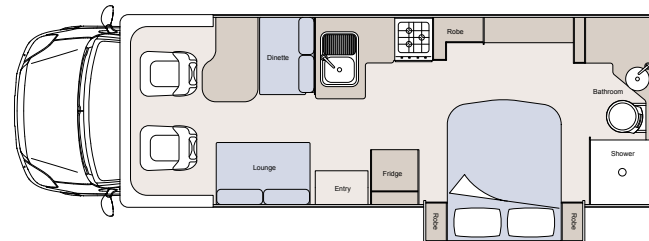

Layout Option: L shape bench in kitchen and L shape lounge.

Length 7.8m

Width 2.47m

Height 3.25m

H507

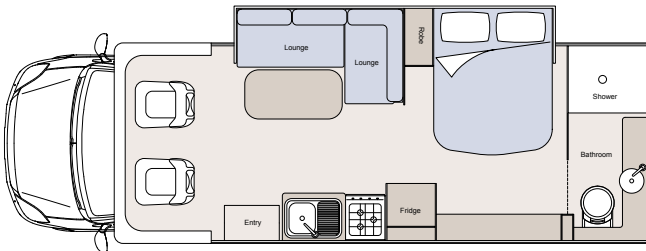

Layout Option: L shape bench in kitchen and dinette lounge

Length 7.5m

Width 2.47m

Height 3.25m

H532

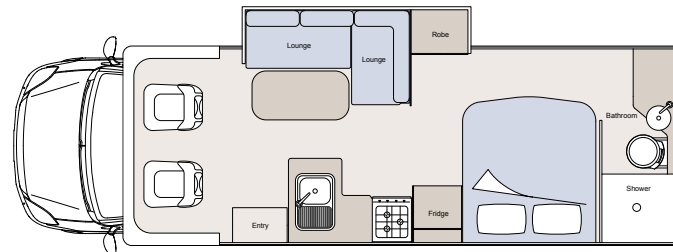

Layout Option: Straight bench in kitchen and dinette lounge

Length 7.8m

Width 2.47m

Height 3.25m

H533

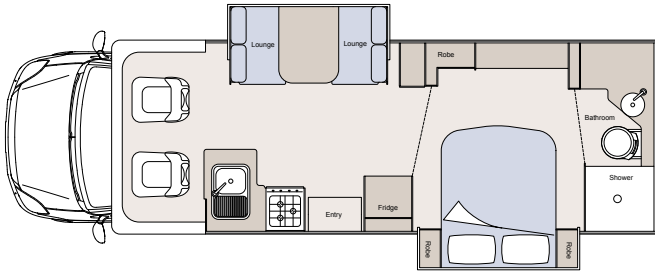

Layout Option: Straight bench in kitchen and dinette lounge

Length 7.8m

Width 2.47m

Height 3.25m

H601

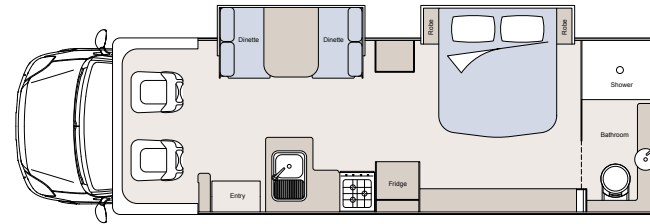

Layout Option: Straight bench in kitchen

Length 8.5m

Width 2.47m

Height 3.25m

H534

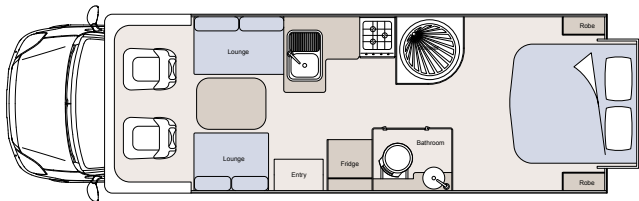

Layout Option: Straight bench in kitchen

Length 7.8

Width 2.47m

Height 3.25m

H602

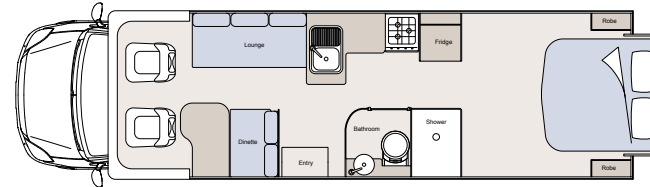

Length 8.5m

Width 2.47m

Height 3.25m

H535

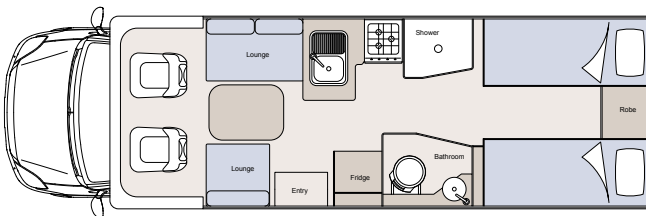

Length 7.8m

Width 2.47m

Height 3.25m

H603

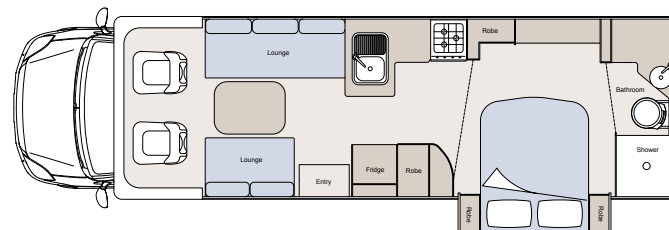

Length 8.5m

Width 2.47m





Height 3.25m

2

Choose your Chassis

The foundation of your Holiday

Your chassis is the foundation to your motorhome. When choosing the correct chassis it is important to consider your style of travel and who will be doing the driving. Decisions such as towing capacities transmissions, fuel types and GVMs need also to be considered.

| | H501 | H502 | H503 | H504 | H505 | H506 | H507 | H508 | H531 | H532 | H533 | H534 | H535 | H601 | H602 | H603 |
|--|------|------|------|------|------|------|------|------|------|------|------|------|------|------|------|------|
|  Mercedes Benz 516 | • | • | • | • | • | • | • | • | • | • | • | • | • | | | |
|  Mercedes Benz 519 | • | • | • | • | • | • | • | • | • | • | • | • | • | | | |
| IVECO Daily 70C 17 | • | • | • | • | • | • | • | • | • | • | • | • | • | • | • | • |
| IVECO Daily 50C 17 | • | • | • | • | • | • | • | • | • | • | • | • | • | | | |
| IVECO Daily 45C 17 | • | • | • | • | • | • | | • | | | | | | | | |
|  Ducato X250 | • | • | • | • | • | • | | • | | | | | | | | |
|  Renault Master X62 | • | • | • | • | • | • | | • | | | | | | | | |





The Renault Master Cab Chassis has been ergonomically designed to ensure you feel as good at the end of the day as you did at the start. Driven by a powerful 2.3L Turbo Diesel engine that produces all the grunt you need while keeping fuel consumption to a minimum.

Renault Master X62

| Engine | Power (hp/kw) | Torque (Nm) | GVM (kg) | Front Axle Capacity | Rear Axle Capacity | Gear | Fuel Tank Capacity (Litres) | Driven wheels | Tyre Size | Anti-Lock Brakes (ABS) | Traction Control | Stability Control | Roadside Assistance (varying duration) | Warranty Period (Years/Km's) |
|---------|---------------|-------------|----------|---------------------|--------------------|--------------|-----------------------------|---------------|-----------|------------------------|------------------|-------------------|--|------------------------------|
| 2.3L TD | 148/110 | 350 | 4495 | 3200 | 3000 | 6 speed Auto | 105 | Rear | 195/75R16 | Std | Std | Std | Std | 3/100,000 |



The IVECO Daily, is the light commercial vehicle range of the IVECO Trucks line up. The Daily drives like a car, but has the strength you get from a solid steel truck chassis. It is robust, reliable, flexible, comfortable, safe and environmentally friendly.

Iveco Daily 45C17

| Engine | Power (hp/kw) | Torque (Nm) | GVM (kg) | Front Axle Capacity | Rear Axle Capacity | Gear | Fuel Tank Capacity (Litres) | Driven wheels | Tyre Size | Anti-Lock Brakes (ABS) | Traction Control | Stability Control | Roadside Assistance (varying duration) | Warranty Period (Years/Km's) |
|---------|---------------|-------------|----------|---------------------|--------------------|--------------|-----------------------------|---------------|-----------|------------------------|------------------|-------------------|--|------------------------------|
| 3.0L TD | 170/125 | 400 | 4495 | 1900 | 3100 | 6 speed Auto | 100 | Rear Dual | 195/75R16 | Std | Std | Std | Std | 3/200,000 |

Iveco Daily 50C17

| | | | | | | | | | | | | | | |
|---------|---------|-----|-----------|------|------|--------------|-----|-----------|-----------|-----|-----|-----|-----|-----------|
| 3.0L TD | 170/125 | 400 | 4495/5200 | 1900 | 3700 | 6 speed Auto | 100 | Rear Dual | 195/75R16 | Std | Std | Std | Std | 3/200,000 |
|---------|---------|-----|-----------|------|------|--------------|-----|-----------|-----------|-----|-----|-----|-----|-----------|

Iveco Daily 70C17

| | | | | | | | | | | | | | | |
|---------|---------|-----|-----------|------|------|--------------|-----|-----------|-----------|-----|-----|-----|-----|-----------|
| 3.0L TD | 170/125 | 400 | 4495/5200 | 2500 | 5300 | 6 speed Auto | 100 | Rear Dual | 225/75R16 | Std | Std | Std | Std | 3/200,000 |
|---------|---------|-----|-----------|------|------|--------------|-----|-----------|-----------|-----|-----|-----|-----|-----------|





The Ducato is driven by a powerful 3L Turbo Diesel engine and is built for long easy meandering journeys with excellent ergonomics and standard swivel seats. It only requires an oil change every 24,000km and a service after 48,000km or every 12 months. To ensure your peace of mind it's covered by a 3 year/ 200,000km warranty.

Fiat Ducato X250

| Engine | Power (hp/kw) | Torque (Nm) | GVM (kg) | Front Axle Capacity | Rear Axle Capacity | Gear | Fuel Tank Capacity (Litres) | Driven wheels | Tyre Size | Anti-Lock Brakes (ABS) | Traction Control | Stability Control | Roadside Assistance (varying duration) | Warranty Period (Years/Km's) |
|---------|---------------|-------------|----------|---------------------|--------------------|--------------|-----------------------------|---------------|-----------|------------------------|------------------|-------------------|--|------------------------------|
| 3.0L TD | 177/130 | 400 | 4250 | 2100 | 2400 | 6 speed Auto | 90 or 125 | Front | 225/75R16 | Std | Std | Std | Std | 3/200,000 |



Mercedes-Benz

As the van that established a whole vehicle segment, the Sprinter has been ahead of the crowd since 1995. Its 7G-TRONIC 7-speed automatic transmission¹ is testament to that. It is known above all for its outstanding operational reliability, which gives users the freedom to concentrate fully on their journey. The latest generation of the Sprinter lives up to this impressive reputation.

Mercedes Benz Sprinter 516

| Engine | Power (hp/kw) | Torque (Nm) | GVM (kg) | Front Axle Capacity | Rear Axle Capacity | Gear | Fuel Tank Capacity (Litres) | Driven wheels | Tyre Size | Anti-Lock Brakes (ABS) | Traction Control | Stability Control | Roadside Assistance (varying duration) | Warranty Period (Years/Km's) |
|---------|---------------|-------------|-----------|---------------------|--------------------|--------------|-----------------------------|---------------|-----------|------------------------|------------------|-------------------|--|------------------------------|
| 2.4L TD | 163/120 | 360 | 4490/5000 | 1850 | 3500 | 5 speed Auto | 100 | Rear Dual | 195/75R16 | Std | Std | Std | Std | 3/200,000 |

Mercedes Benz Sprinter 519

| Engine | Power (hp/kw) | Torque (Nm) | GVM (kg) | Front Axle Capacity | Rear Axle Capacity | Gear | Fuel Tank Capacity (Litres) | Driven wheels | Tyre Size | Anti-Lock Brakes (ABS) | Traction Control | Stability Control | Roadside Assistance (varying duration) | Warranty Period (Years/Km's) |
|-----------|---------------|-------------|-----------|---------------------|--------------------|--------------|-----------------------------|---------------|-----------|------------------------|------------------|-------------------|--|------------------------------|
| 2.9 V6 TD | 190/140 | 440 | 4490/5000 | 1850 | 3500 | 7 speed Auto | 100 | Rear Dual | 195/75R16 | Std | Std | Std | Std | 3/200,000 |



3

Choose your Peak

Low Profile Peak

The sleek low profile peak provides an aerodynamic contoured shape that enhances fuel consumption and driving performance.

The low profile peak allows for easy access storage or a temporary bed for the grandkids.



Sleeper Peak

For a permanent sleeping arrangement the high sleeper peak is ideal.

Whilst maintaining Sunliner's sleek look this peak has been designed for a queen bed and includes windows, mattress, ladder, protective bunk net and lighting.

Please note: Peak selected will affect overall vehicle height. Peak Sky Hatch is available with both peaks as an optional extra.



4

Choose your Style

AERO



Packed with functionality, with simple flush fitting doors and modern upholstery, this interior will adapt to any setting from the bush of the outback to the sand dunes of the coast.

Square set bench tops with durable ABS edging and radius corners add to the form of this design. The choice of two timber colours allows further style personalisation. The tone of the Aero design creates a clear, minimalist atmosphere that is easy to maintain and enjoy.

EURO



With soft flowing curves and radius bench tops, this style is classic European. Colour matched furniture and walls give a warm feel to this interior. Brushed aluminium D handles add a subtle highlight, whilst increasing functionality.

The sweeping contours of the upholstery add to this interior making it a place of beauty and comfort. The curved doors enhance the appeal of this finish

POLO



Featuring a Scandinavian influence with subtle colour palettes, natural materials and simple design flawlessly intergrate.

The flush mounted overhead doors set amongst a bordering frame of contrasting material add a clean and stylish mood to this décor.

Clean-cut lines and a square set cabinets add a modern feel. Gloss white doors reflect the light and give an exceptional sense of space. The straight edge style of the lounges add to the modern feel.

KOBE



This modern light filled interior boasts a clever fusion of sleek and soothing materials that come together to give a finish that is a hybrid of classic and modern.

Clean-cut lines meet curved radius doors and bench tops, whilst shaped upholstery with detailed borders blends together to create a unique contemporary ambiance.

The polished aluminium overhead doorframes inserted with gloss white material leaves the interior feeling fresh and light. The choice of light or dark timber will allow you to express your personality in this high-end finish.

CINO



From the moment you step inside this beautiful interior you will sense an aura of luxurious beauty.

Hand polished hard woods combined with smooth flowing curves give the Cino a classic opulence. Flush mount push button handles add a subtle touch without detracting from the full radius furniture design.

Plush upholstered lounges add to the tone, whilst the warm lighting delivers a rich relaxing atmosphere.

MONDO



This stylish high gloss finish encapsulates modern design and presents the pinnacle of luxury.

Flush overhead doors, concealed hardware and clean internal edges give the Mondo an ultra modern feel.

Square set upholstery enhances the modern attitude. Neutral wall linings provide a platform for a subtle or vast contrast upon your choice of timber and door colours. The waterfall inspired infinity bench tops is the final word in elegance.

5

Choose your Finish

Finish Choices

Once you have chosen your interior cabinetry you can move onto the fun part and choose your interior design details. This is where your Holiday will truly become a reflection of your needs and taste and will be personalised for your journey.

There are hundreds of different possible combinations of interior elements. Visit our website (www.sunliner.com.au) to view the full range of colour samples. We also encourage you to discuss with your Sunliner specialist. They have seen hundreds of motorhomes and will be able to answer your questions to ensure you are 100% confident in your choices.





Holiday Interior Finish

Interior design is the finishing touch, it is important as it transform a space from one that is only functional to an environment that is truly beautiful.

6

Choose your Specifications

| | 1 | 2 | 3 |
|----------------------------------|---------------------------|---------------------------|---------------------------|
| CABIN | | | |
| Drivers Swivel Seat | Layout Specific | Layout Specific | Layout Specific |
| Passenger Swivel Seat | Layout Specific | Layout Specific | Layout Specific |
| Cabin Seat Trim | Insert Only | Full matching to home | Full matching to home |
| Cabin Floor Carpet | Option | Option | Standard |
| Reverse Camera | Standard | Standard | Standard |
| Cabin Reading Lights | N/A | Standard | Standard |
| KITCHEN | | | |
| Fridge - 2 Door | 190 Ltr | 190 Ltr | 190 Ltr |
| Cooker | 3 Burner Gas Oven & Grill | 3 Burner Gas Oven & Grill | 3 Burner Gas Oven & Grill |
| Microwave | Standard | Standard | Standard |
| Splashback | Standard | Standard | Standard |
| LIGHTING | | | |
| Ceiling Lights | LED | LED | LED |
| Reading Lights | LED | LED | LED |
| POWER SYSTEM | | | |
| 240V Charger | 25A | 25A | 25A |
| In House Battery | 1 x 100Ah | 1 x 100Ah | 2 x 100Ah |
| Solar Panel & Regulator | Option | 1 x 80Watt | 1 x 135Watt |
| Inverter | Option | Option | Standard |
| PLUMBING | | | |
| Toilet | Thetford C200 | Thetford C200 | Thetford C250 |
| Hot Water Service | Gas Only | Gas / Electric | Gas / Electric |
| Fresh Water Capacity | 100ltr | 100ltr | 100ltr |
| Grey Water Capacity | 55ltr | 55ltr | 55ltr |
| External Shower | Option | Option | Standard |
| Gas Bottles - 4kg or 9kg | Layout Specific | Layout Specific | Layout Specific |
| CLIMATE | | | |
| Air Conditioner | Standard | Standard | Standard |
| Diesel Central Heating | Option | Option | Standard |
| Roof Hatch | Standard | Standard | Standard |
| EXTERNAL | | | |
| Awning | N/A | Roll Out | Electric Roll Out |
| Windows | Seitz Double Glazed | Seitz Double Glazed | Seitz Double Glazed |
| Entry Step | Manual | Electric | Electric |
| External Roof Bars | N/A | Standard | Standard |
| Fibreglass Side Mouldings | Standard | Standard | Standard |
| Fibreglass Bumper & Spoiler | Standard | Standard | Standard |
| Cabin Entry Steps | Standard | Standard | Standard |
| ENTERTAINMENT | | | |
| LCD TV with in built DVD Player | N/A | 19 Inch | 22 Inch |
| CD Player with Internal Speakers | N/A | Standard | Standard |
| External Speakers | N/A | Option | Standard |
| Tv Antenna | N/A | Standard | Standard |
| FURNISHINGS | | | |
| Mattress | Innerspring | Innerspring | Innerspring |
| Upholstery | Fabric | Fabric | Fabric |

Highlights Pack

The ultimate in luxury. Spoil yourself with this package and enjoy the prestige and opulence you deserve.

- Full Euro Bumper Kit
- Dual Switch Lighting
- LED Feature Strip Lighting
- Bulkheads with LED Down Lights
- Awning Strip Lighting
- Courtesy Cabin Entry Lighting
- Raised Kitchen Bench Extension
- Plush Leather Upholstery

Optional Extras

While we would love to fit everything standard in all models, sometimes they don't fit in some layouts. The below extras can be added to any specification if applicable to the layout.

- Peak Sky Hatch
- Electric TV Lift (layout Specific)
- Plush Leather Upholstery
- Bike Rack
- Washing Machine
- TV upgrade
- Satellite TV (Dealer Option)

What sets us apart

Rear to Tow, Front to Go.

Sunliner offer more layouts on a greater variety of chassis than any other.

Quality

Concealed spring assisted adjustable hinges are used for smoother assisted opening.

It's the things you don't see that counts.

Furniture is sealed around the floor so if you drop the milk it won't leach into the furniture.

Locked tight, made right.

Walls are rebated and interlocked for a stronger construction with more support.



Steel Sub Chassis

Stronger than a panel floor allows a strong foundation with less movement in the vehicle body. More secure mounting for walls, tanks & bins.

It's what you don't see that counts.

All Fibreglass fairings are neatly screwed & glued in a way that they can't be seen; giving a neater appearance and assists in a cleaner unit.

No Frame, More Gain

The innovative ThermoTough Wall, allows the unit to be built without a rigid frame. Mounting can be made at any point internally or externally directly into the seamless 12mm core.

Floor

One piece floor has no joins and is fully sealed underneath. Internal floor coverings are high quality and insulated.



ThermoTough™ Wall

The Toughest Walls on the Market

Sunliner's ThermoTough wall is a revolutionary design encompassing strength, durability and weight reducing properties.

- Lightweight European technology.
- One piece wall. No joins, No gaps equals greater strength.
- Popular cross ply/Duplo Foam core provides extremely strong panel with a high impact rating.
- Most repairs can be localised without replacing whole wall.
- All materials used in the process have a similar expansion rates.
- Walls can be screwed into at any point. No studs or fixing points necessary.
- Walls R rating is equivalent to those found in extreme alpine areas.

DuraRoof™

Strong enough to Party On

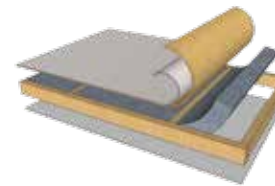

Sunliner's DuraRoof has been precision engineered to provide superior structural strength.

- Fully insulated bonded core.
- Reinforced timber structure combined with compressed Duplo Foam.

Evolution of a Sunliner Motorhome



Sub Chassis



Floor Down



Furniture On



Walls & Roof On



Quality Assurance Testing

Personalise your journey...



CAMPERVANS

Consisting of pop top and full bodied vans our range of campervans are based on a choice of chassis including Toyota Hiace, Fiat Ducato, Renault and Mercedes Benz.



RANGER

Available in 2x4 or 4x4, with Diesel or Gas appliances; you now have the freedom to go almost anywhere.



VIBE

The Vibe is a fun compact motorhome with lots of personality - just like it's owners!



VIDA

The Sunliner Vida series is modern finish that is, practical and simple to maintain and use vehicles. A great place to start.



PINTO

Offering electric drop-down bed and island bed layouts, this range encompasses the best of a touring van in a compact stylish package.



HOLIDAY

The Sunliner 6 Step Process to Personalisation offers you the widest choice of layouts, chassis, peaks, styles and specifications. This range offers drop down beds, slide out walls and everything in between.



TWIST

The Twist is master of space creation, with a slide-out dining area creating a generous living space. A dry ensuite and fixed east-west bed all in a 25 foot motorhome package, complete this stunning Motorhome.



SUNLINER 40

A celebration of Sunliners 40 years of manufacturing the most beautiful of motorhomes. The 40 is packed with innovation and cutting edge style that makes a statement.



MONTE CARLO

The Flagship of the Sunliner range the Monte Carlo is in a class of its own. The finest trims, plus leather upholstery, curved cabinetry and soft lighting.

Please note that some layouts may not accommodate the standard items listed in this brochure. The closest alternative will be fitted. All capacities, weights and measurements listed are approximates. All specifications and options on this brochure may be charged at any given time according to availability and supply. Floor plans are dependent on chassis type and dimensions may change depending on base chassis. Images shown may not depict the actual model or may contain items not standard or available with specific model. It is the customer's responsibility to ensure that the vehicle purchased is suited to their needs. This brochure may not be relevant to dealer stock units purchased or second-hand units. This brochure should be used as a guide only.

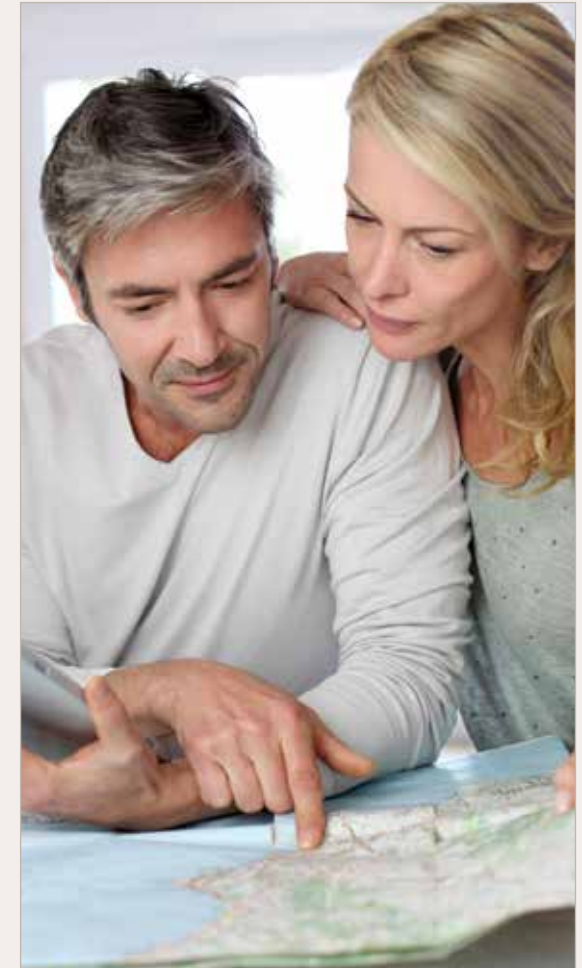

www.sunliner.com.au