

# VIDA



Sunliner Motorhomes



## A great place to start

The Sunliner Vida series is an entry point to the Sunliner range of motorhomes and campervans. The Vida is designed to offer a well-equipped, simple and modern vehicle with all the essentials you need to start your journey, today.



Vida V242



## Vida Motorhomes

On board the Vida you will find abundant storage and sleek lines. The list of "standard" features includes rear vision camera, microwave, and awning, with an en-suite with shower and toilet, a fixed island bed and kitchen all coupled with the Sunliner craftsman standard of finish and construction.

The finish is a celebration of simple modern and practical design, making it a pleasure to maintain and use.

## Vida Campervans

The Vida campervan is an ideal size to use as a drive car during the week and adventure vehicle for the weekend. You no longer need to make a choice – you can have it all!

# Chassis



The Ducato is driven by a powerful 3L Turbo Diesel engine and is built for long easy meandering journeys with excellent ergonomics and standard swivel seats. It only requires an oil change every 24,000km and a service after 48,000km or every 12 months. To ensure your peace of mind it's covered by a 3 year/ 200,000km warranty.

## Fiat Ducato X295

Engine	Power (hp/kw)	Torque (Nm)	GVM (kg)	Front Axle Capacity	Rear Axle Capacity	Gear	Fuel Tank Capacity (Litres)	Driven wheels	Tyre Size	Anti-Lock Brakes (ABS)	Traction Control	Stability Control	Roadside Assistance (varying duration)	Warranty Period (Years/Km's)
3.0L TD	177/130	400	4005	2100	2400	6 speed Auto	90	Front	225/75R16	Std	Std	Std	Std	3/200,000

NOTE: Available on Vida 241, 242, 251 Motorhomes and V21, V22, V23 Campervans.



The Renault Master Cab Chassis has been ergonomically designed to ensure you feel as good at the end of the day as you did at the start. Driven by a powerful 2.3L Turbo Diesel engine that produces all the grunt you need while keeping fuel consumption to a minimum.

## Renault Master X62

Engine	Power (hp/kw)	Torque (Nm)	GVM (kg)	Front Axle Capacity	Rear Axle Capacity	Gear	Fuel Tank Capacity (Litres)	Driven wheels	Tyre Size	Anti-Lock Brakes (ABS)	Traction Control	Stability Control	Roadside Assistance (varying duration)	Warranty Period (Years/Km's)
2.3L TD	148/110	350	4495	3200	3000	6 speed Auto	105	Rear	195/75R16	Std	Std	Std	Std	3/100,000

NOTE: Available on Vida 241, 242, 251 Motorhomes and V21, V22, V23 Campervans.



An Australian classic for over 35 years; the Toyota Hiace is a workhorse. It has been refined to meet the demands of the modern driver. The cabin has been designed to optimise space and provide support for long days at the wheel.

## Toyota Hiace 200

Engine	Power (hp/kw)	Torque (Nm)	GVM (kg)	Front Axle Capacity	Rear Axle Capacity	Gear	Fuel Tank Capacity (Litres)	Driven wheels	Tyre Size	Anti-Lock Brakes (ABS)	Traction Control	Stability Control	Roadside Assistance (varying duration)	Warranty Period (Years/Km's)
3.0L TD	124/100	300	2800	1550	1550	4 speed Auto	70	Front	195R15	Std	No	No	Optional	3/100,000

NOTE: Available on VPRF and VPRR Campervans.

## No one knows what works for you, better than you

You know what works for you, that is why at Sunliner we think you also know what you are looking for in a recreational vehicle (RV). Our philosophy is to listen and work with you to create your dream vehicle.

We understand that you want your new RV to feel like a home and we don't believe you should have to compromise.

Our vehicles do not come from an offshore assembly line, with a single mould for everyone. Each Sunliner RV is built in Australia by our skilled team who are excited to manufacture recreational vehicles tailored to your needs.

Sunliner is proud to be an Australian owned family business. We have been manufacturing outstanding motorhomes and campervans for over 40 years. It is our innovation and our attention to detail that sets Sunliner apart as Australia's premium brand of Recreational Vehicles.

We look forward to assisting you to personalise your journey.



# Layout

## Vida Motorhomes

V241

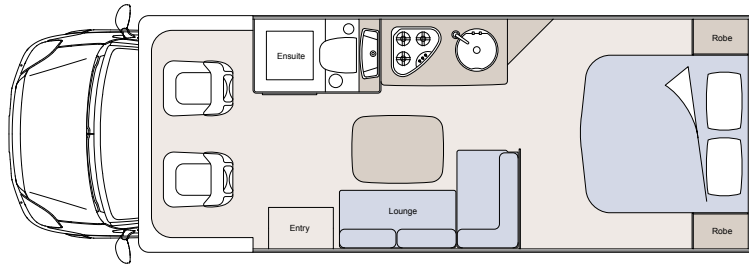

Length 7.2m

Width 2.4m

Height 2.9m



Vida V242

V242

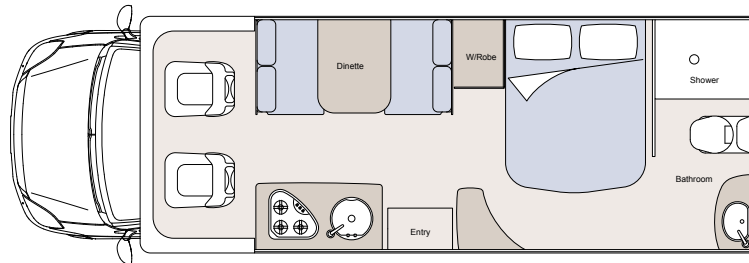

Length 7.2m

Width 2.4m

Height 2.9m



Vida V242

V251

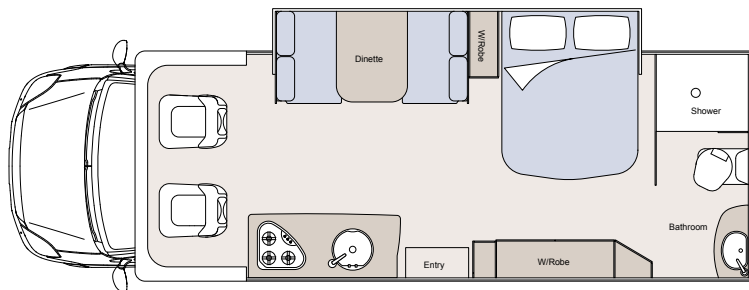

Length 7.2m

Width 2.4m

Height 2.9m

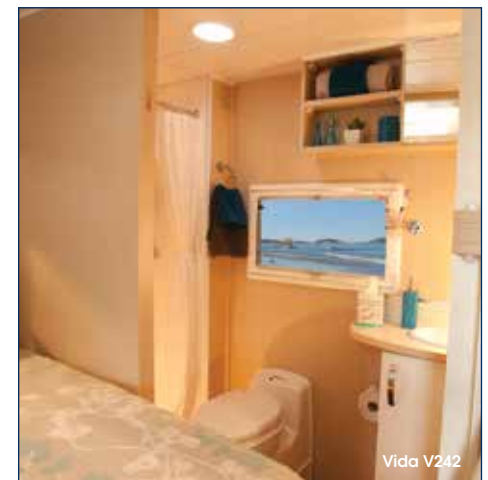

Vida V242

## Campervans

V21

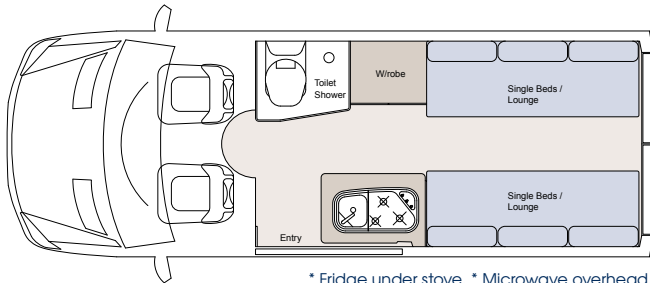

\* Fridge under stove. \* Microwave overhead.  
Note: Beds slide together to make Large Double Bed.

- Length 6m
- Width 2.1m
- Height 2.8m

V22

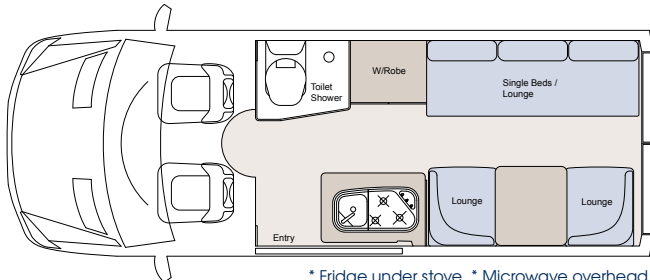

\* Fridge under stove. \* Microwave overhead.  
Note: Beds slide together to make Large Double Bed.

- Length 6m
- Width 2.1m
- Height 2.8m

V23

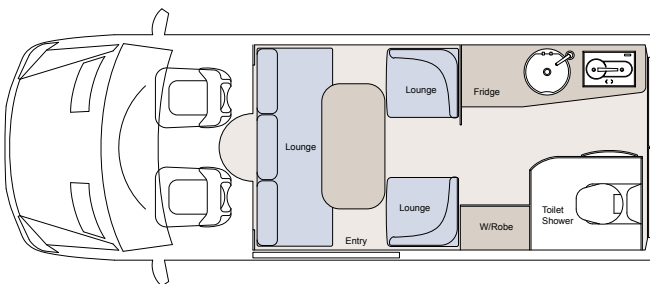

- Length 6m
- Width 2.1m
- Height 2.8m

## Vida Pop-Top Roof Campervan

VPRF

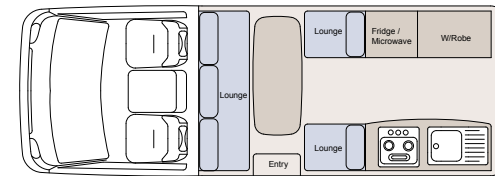

- Length 4.7m
- Width 1.7m
- Height 2.05m

VPRR

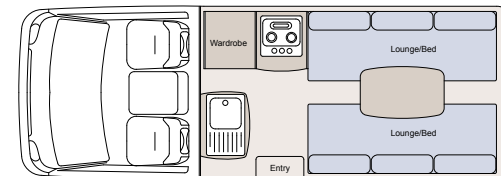

- Length 4.7m
- Width 1.7m
- Height 2.05m

## So many reasons to own a Campervan

Maybe it is pure nostalgia; a desire to go back to a simpler way to travel and explore. For others it is all about convenience; the perfect and practical vehicle for their travelling and outdoors lifestyle with the ability to take a shower after a surf or a run and then head on to the next activity without going home. For some it is a necessity; a "home base" when you are working in remote or un-serviced areas. No matter what your reasons, the freedom to travel whenever and wherever your heart takes you is what makes a Sunliner Vida Campervan an ideal travel companion.

# Specifications

## V241 / V242 / V251

## V21 / V22 / V23

## VPRF / VPRR

	V241 / V242 / V251	V21 / V22 / V23	VPRF / VPRR
<b>CABIN</b>			
Drivers Swivel Seat	Standard	Standard	NA
Passenger Swivel Seat	Standard	Standard	NA
Cabin Seat Trim	Standard	Standard	Standard
Cabin Floor Carpet	Optional	NA	NA
Reverse Camera	Standard	Optional	Standard
<b>KITCHEN</b>			
Fridge	90 Ltr	80 Ltr	60 Ltr - 3 way
Cooker	3 Burner with Glass Lid	3 Burner with Glass Lid	2 Burner & Grill
Microwave	Standard	Standard	Standard
Splashback	Stainless	NA	NA
<b>LIGHTING</b>			
Ceiling Lights	LED	LED	LED
Reading Lights	LED	LED	LED
<b>POWER SYSTEM</b>			
25 Amp Converter / Charger	Standard	Standard	Standard
In House Battery	1 x 100Ah	1 x 100Ah	1 x 75Ah
Solar Panel & Regulator	Optional	Optional	Optional
Inverter - 1000 Watt	Optional	Optional	Optional
<b>PLUMBING</b>			
Toilet	Thefford C200	Thefford C200	NA
Hot Water Service	Gas / Electric	Gas / Electric	NA
Fresh Water Capacity	100ltr	100ltr	30ltr
Grey Water Capacity	55ltr	55ltr	NA
Gas Bottles	2 x 4kg	2 x 4kg	1 x 4kg
<b>CLIMATE</b>			
Air Conditioner	Standard	Optional	Optional
Diesel Central Heating	Optional	Optional	NA
Roof Hatch	Standard	Standard	Standard
<b>EXTERNAL</b>			
Awning	Wind Out	Optional	NA
Windows	Double Glazed Single Hopper	Double Glazed Single Hopper	NA
Entry Step	Pull Out	Pull Out	NA
External Roof Bars	Standard	NA	NA
Fibreglass Side Mouldings	Standard	NA	NA
Fibreglass Bumper & Spoiler	Standard	NA	NA
External Power Point	Standard	Standard	Standard
External Grab Handle	Standard	NA	NA
External Shower	Optional	Optional	NA
Back End Tent	NA	Optional	Optional
<b>ENTERTAINMENT</b>			
LCD TV with in built DVD Player	Optional	Optional	NA
CD Player with Internal Speakers	Optional	Optional	NA
External Speakers	Optional	Optional	NA
Tv Antenna	Standard	Optional	NA
<b>FURNISHINGS</b>			
Mattress	Innerspring	5" Foam	5" Foam
Upholstery	Fabric	Fabric	Fabric
Roof Bed Boards	NA	NA	Optional



# What sets us apart

## Rear to Tow, Front to Go.

Sunliner offer more layouts on a greater variety of chassis than any other.

## Quality

Concealed spring assisted adjustable hinges are used for smoother assisted opening.

## It's the things you don't see that counts.

Furniture is sealed around the floor to prevent spills getting into unreachable places.

## Locked tight, made right.

Walls are rebated and interlocked for a stronger construction with more support.



## Steel Sub Chassis

Stronger than a panel floor allows a strong foundation with less movement in the vehicle body. More secure mounting for walls, tanks & bins.

## It's what you don't see that counts.

All Fibreglass fairings are neatly screwed & glued in a way that they can't be seen; giving a neater appearance and assists in a cleaner unit.

## No Frame, More Gain

The innovative ThermoTough Wall, allows the unit to be built without a rigid frame. Mounting can be made at any point internally or externally directly into the seamless 12mm core.

## Floor

One piece floor has no joins and is fully sealed underneath. Internal floor coverings are high quality and insulated.



## ThermoTough™ Wall

*The Toughest Walls on the Market*

Sunliner's ThermoTough wall is a revolutionary design encompassing strength, durability and weight reducing properties.

- Lightweight European technology.
- One piece wall. No joins, No gaps equals greater strength.
- Popular cross ply/Duplo Foam core provides extremely strong panel with a high impact rating.
- Most repairs can be localised without replacing whole wall.
- All materials used in the process have a similar expansion rates.
- Walls can be screwed into at any point. No studs or fixing points necessary.
- Walls R rating is equivalent to those found in extreme alpine areas.

## DuraRoof™

*Strong enough to Party On*

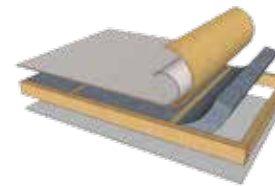

Sunliner's DuraRoof has been precision engineered to provide superior structural strength.

- Fully insulated bonded core.
- Reinforced timber structure combined with compressed Duplo Foam.

## Evolution of a Sunliner Motorhome



Sub Chassis



Floor Down



Furniture On



Walls & Roof On



Quality Assurance Testing

# Personalise your journey...



## CAMPERVANS

Consisting of pop top and full bodied vans our range of campervans are based on a choice of chassis including Toyota Hiace, Fiat Ducato, Renault and Mercedes Benz.



## RANGER

Available in 2x4 or 4x4, with Diesel or Gas appliances; you now have the freedom to go almost anywhere.



## VIBE

The Vibe is a fun compact motorhome with lots of personality - just like it's owners!



## VIDA

The Sunliner Vida series is modern finish that is, practical and simple to maintain and use vehicles. A great place to start.



## PINTO

Offering electric drop-down bed and island bed layouts, this range encompasses the best of a touring van in a compact stylish package.



## HOLIDAY

The Sunliner 6 Step Process to Personalisation offers you the widest choice of layouts, chassis, peaks, styles and specifications. This range offers drop down beds, slide out walls and everything in between.



## TWIST

The Twist is master of space creation, with a slide-out dining area creating a generous living space. A dry ensuite and fixed east-west bed all in a 25 foot motorhome package, complete this stunning Motorhome.



## SUNLINER 40

A celebration of Sunliners 40 years of manufacturing the most beautiful of motorhomes. The 40 is packed with innovation and cutting edge style that makes a statement.



## MONTE CARLO

The Flagship of the Sunliner range the Monte Carlo is in a class of its own. The finest trims, plus leather upholstery, curved cabinetry and soft lighting.

Please note that some layouts may not accommodate the standard items listed in this brochure. The closest alternative will be fitted. All capacities, weights and measurements listed are approximates. All specifications and options on this brochure may be charged at any given time according to availability and supply. Floor plans are dependent on chassis type and dimensions may change depending on base chassis. Images shown may not depict the actual model or may contain items not standard or available with specific model. It is the customer's responsibility to ensure that the vehicle purchased is suited to their needs. This brochure may not be relevant to dealer stock units purchased or second-hand units. This brochure should be used as a guide only.

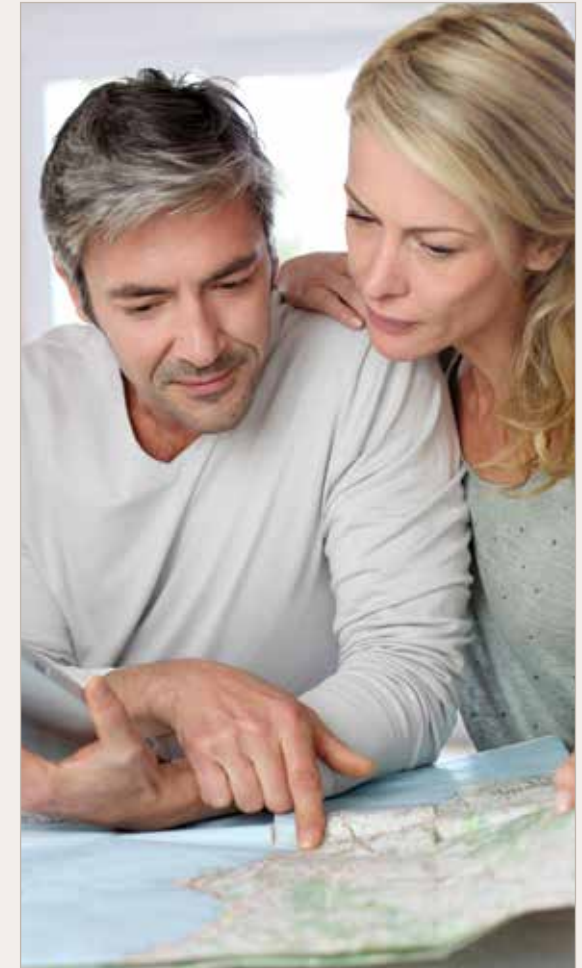

[www.sunliner.com.au](http://www.sunliner.com.au)